



# NightSnipe™

## INDUSTRIAL LIGHTING



# SPECIFICATION

Aura IP66 Tri-proof Light

## Product Details



## Features

- CE, RoHs, ERP, TUV-GS, SAA, UL, DLC certified
- Water-proof, Dust-proof, Damp-proof, Vapor-proof
- Unique design, Mitsubishi PC Cover + Aluminum housing + Aluminum PCB
- IP66 IK10
- Global patent protection led source, SMD2835
- Capable with non-dimming, 0~10V dimming, DALI, Sensor, Emergency version
- Available in side connection, back connection, plug-and-play in connection, self-wiring connection
- 100~120lm/w or 125~145lm/w
- L80B50 lifespan(Ta=25°C): 70,000hrs
- 5 years warranty.

## Application

- Parking place
- Tunnel / Corridor / Gallery
- Railway / Bus / MTR Station
- Warehouse / Factory
- Airport
- Exhibition Hall
- Supermarket
- Gas station



## Product Details

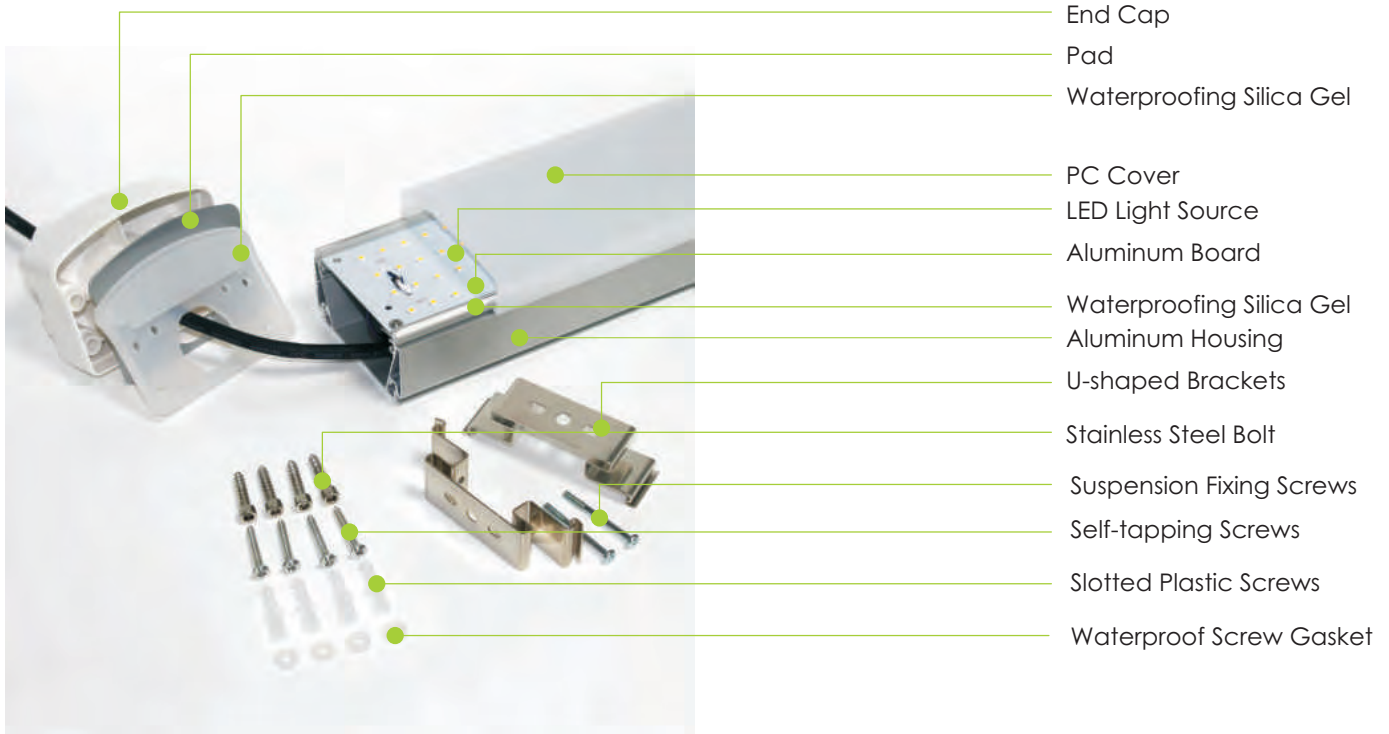

## Dimension

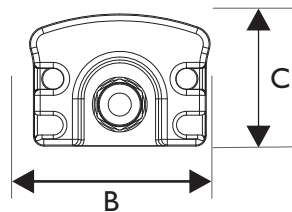
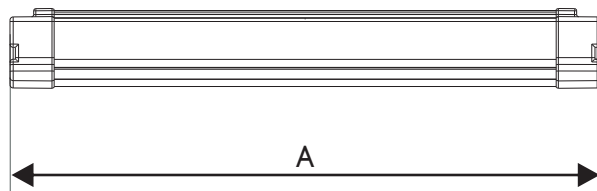

length

A

B

C

Min.mm

Min.mm

Max.mm

Min.mm

600

600

93

94

69

1200

1200

93

94

69

2400

2400

93

94

69

## Flexibilities in connection

### 1 Power at one end

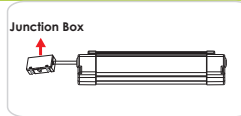

Fit for single connection

### 2 Power at double ends

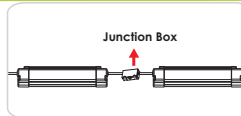

Fit for series connection

### 3 Power at backside

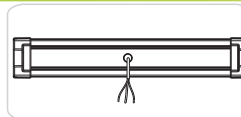

Fit for backside or wall mounted connection

### 4 Detachable caps

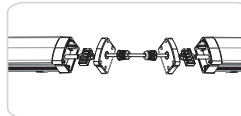

Fit for self-wiring connection

### 5 Plug-and-play connection with LLT connectors

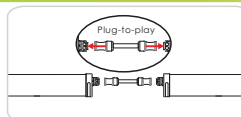

Fit for plug-and-play connection

## Emergency Version

Article Number	Emergency Time(hours)	Emergency Power(W)	Battery Parameters
NS-2-20VT-SL	3	3	3.6V 2600mah
NS-2-30VT-SL	3	4	7.2V 2200mah
NS-4-40VT-SL	3	4	7.2V 2200mah
NS-4-50VT-SL	3	8	7.2V 4400mah
NS-4-60VT-SL	3	8	7.2V 4400mah
NS-8-100VT-SL	N/A	N/A	N/A

## Wiring Diagram

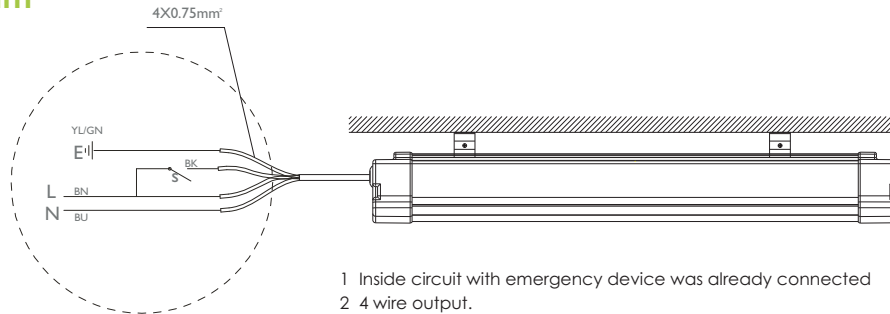

- 1 Inside circuit with emergency device was already connected
- 2 4 wire output.  
Eu Market: Blue-Neutral wire / Black-Live wire / Brown-Switch wire / Yellow&Green-Earth wire  
US Market: Black-Neutral wire / White-Live wire / Red-Switch wire / Green-Earth wire
- 3 Indicator color (Green – main power, Yellow – malfunction, Red - Charging)
- 4 Battery can be recharged at least 500 times. In order to maintain the battery well it must be discharged every 3 months.

MSDS Test Report is available

# Hytronik Microwave Sensor 100% on/off version

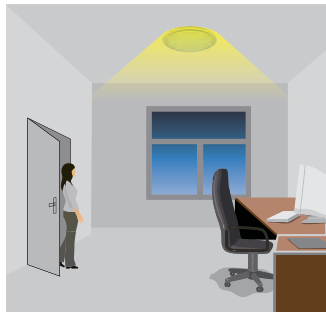
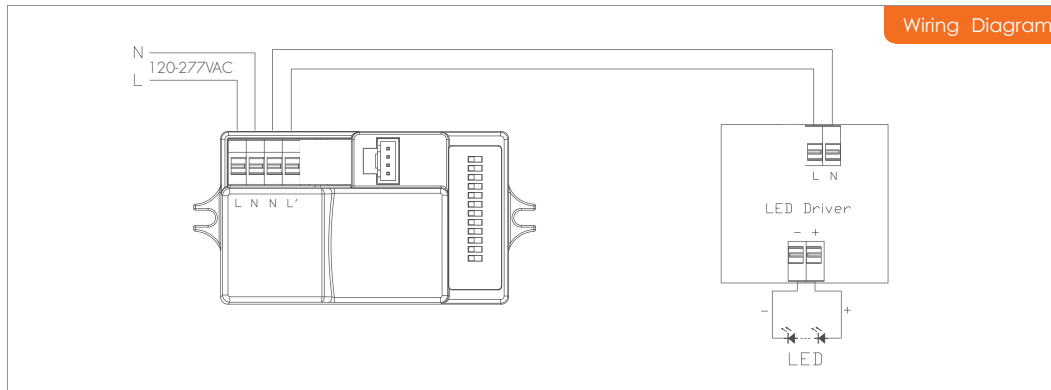

Light will turn on if any movement is detected in detection area.

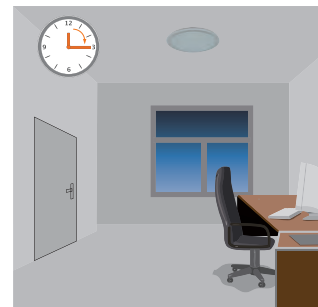

Light will switch off after the hold time if no movement in detection area.

Remark: 1. standard hold time is 60s 2. Max detection range is 12x6m(φxh)

# Microwave Sensor Module Brightness Dimming Version

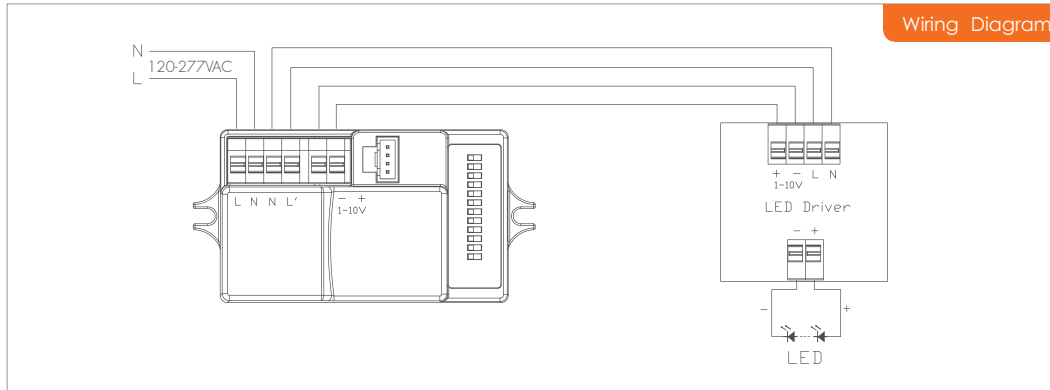

Light will turn on if any movement is detected in detection area.



Light will dim to 10%/20%/30%/50%(options) after the hold time when no movement in detection area

Remark: 1. standard hold time is 60s 2. Max detection range is 12x6m( $\phi$ xh)



# Installation

## ① Ceiling Mounted Installation

Tighten the screw with screwdriver

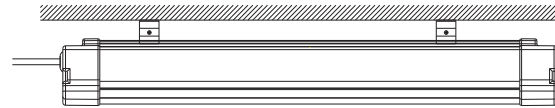
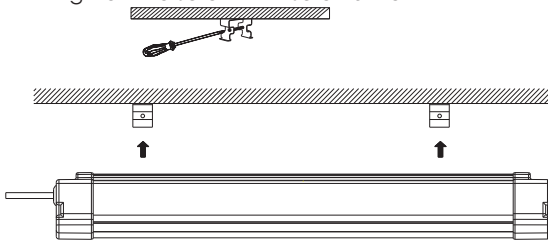

\* Ceiling Mounted accessories are NightSnipe Configuration.

## ② Hanging Installation

Tighten the screw with screwdriver.

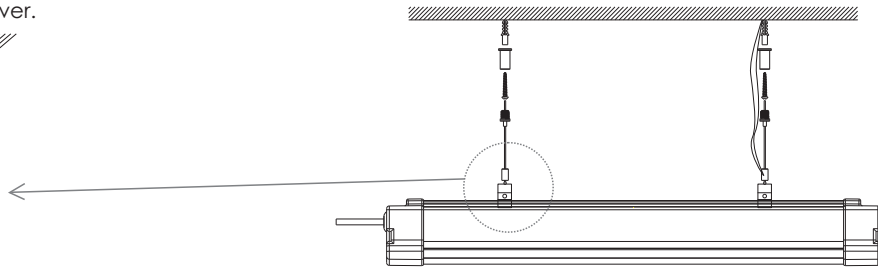
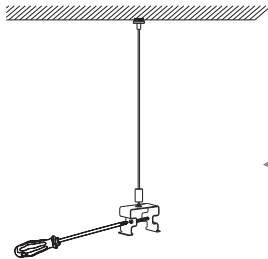

\* Suspended accessories need to be paid additionally.